



ASSEMBLY INSTRUCTIONS

LOKCLIP: Hose repair

(For illustrating the assembly procedure a Hose-to-LOKRING connector is used.)

VULKAN LOKRING

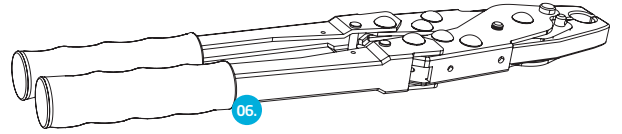
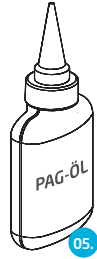
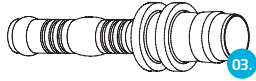
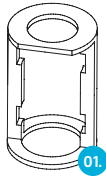

01. Clip position holder **02.** Stainless steel clips **03.** Joint **04.** LOKRING **05.** Refrigerant oil **06.** Hand assembly tool

1 Insert the two stainless steel clips (02) into the clip position holder (01).

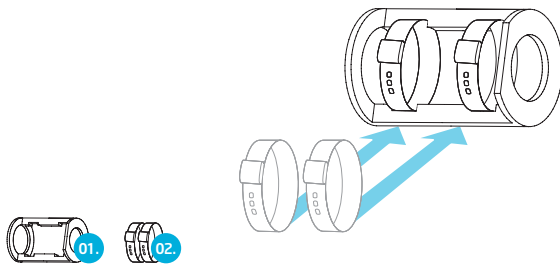

2 Insert the hose into the clip position holder (01) as far as it will go.

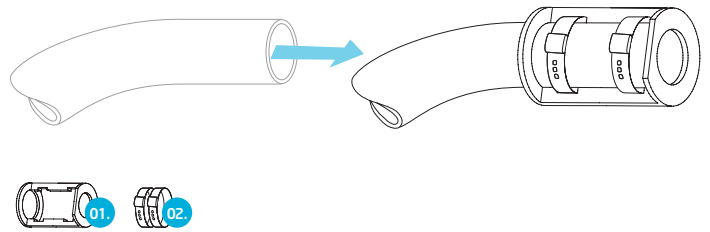

3 Lubricate the joint (03) with a little refrigerant oil (05).

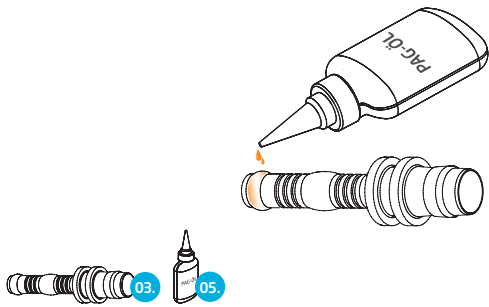

4 Push the joint (03) into the hose as far as it will go.

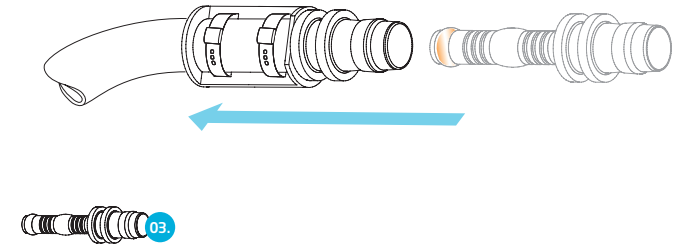

5 Press the stainless steel clips (02) using the hand assembly tool (06). Start with the clip positioned at the side of the hose. As an alternative to the hand assembly tool (06) LOKTOOL MZ-V you can also use the LOKTOOL LC flex (L14003352).

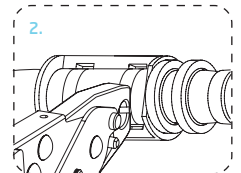
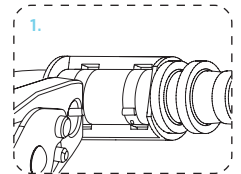
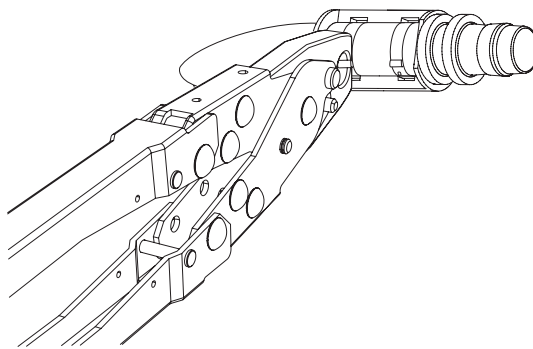
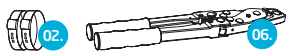
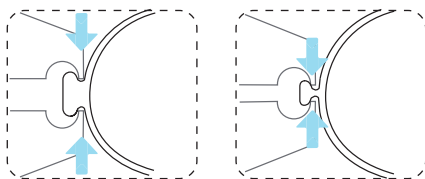

6 Now you can make the LOKRING® connection. Respect the assembly instructions for LOKRING® tube connection assembly version 50 on www.vulkan.com.

